

PROPRIETARY AND CONFIDENTIAL

THE INFORMATION CONTAINED IN THIS DRAWING IS THE SOLE PROPERTY OF DYTRAN INSTRUMENTS INC. ANY REPRODUCTION IN PART OR AS A WHOLE WITHOUT THE WRITTEN PERMISSION OF DYTRAN INSTRUMENTS, INC. IS PROHIBITED

REVISIONS

REV	ECN	DESCRIPTION	BY/DATE	CHK	APPR
B	10676	REVISED "DYTRAN" LOGO	RA, 01/13/14	MH	RA

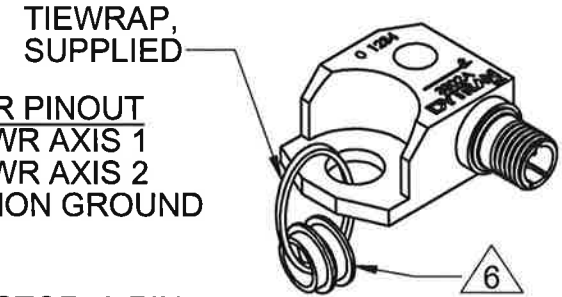
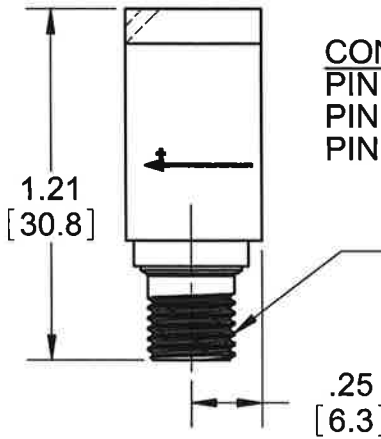
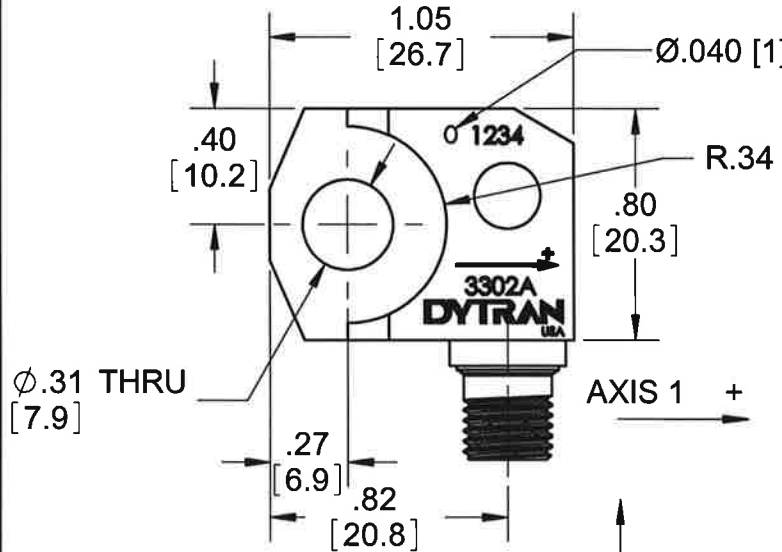

CONNECTOR PINOUT
 PIN A SIG/PWR AXIS 1
 PIN B SIG/PWR AXIS 2
 PIN C COMMON GROUND RET.

CONNECTOR: 3-PIN, 5/16-28 THREAD, HERMETIC

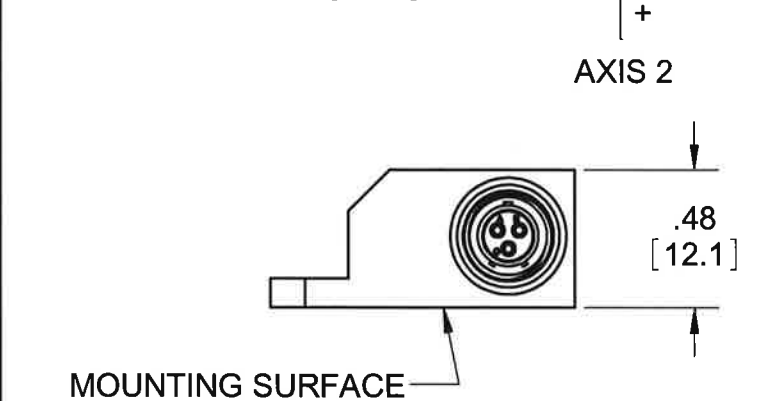

- 6 ADAPTER BUSHING SUPPLIED: 6555 (Ø.250 THRU HOLE) 6555A1(Ø.188, THRU HOLE)
- 5 MATING CONNECTOR: GLENAIR 257-132-3S
- 4. ARROWS SHOW DIRECTION OF ACCELERATIONS FOR POSITIVE-GOING OUTPUT SIGNAL.
- 3. WEIGHT: APPROX 30 GRAMS
- 2. SENSITIVITY: 10 mV/g.
- 1 HOUSING MATERIAL: 316L STAINLESS STEEL. CONNECTOR: 304L S.S.

NOTES: UNLESS OTHERWISE SPECIFIED

3302A	USED ON	NEXT ASSY
APPLICATION		
THIRD ANGLE PROJECTION USA		

UNLESS OTHERWISE SPECIFIED:
 INTERPRET DIM & TOL PER ASME Y14.5M - 1994.
 REMOVE BURRS.
 COUNTERSINK INTERNAL THDS 90° TO MAJOR DIA.
 CHAM EXT THDS 45° TO MINOR DIA.
 THD LENGTHS AND DEPTHS ARE FOR MIN FULL THDS.
 THDS PER MIL-S-7742.
 DIMENSIONS APPLY AFTER FINISHING.

ALL MACHINED SURFACES TOTAL RUNOUT WITHIN .005.
 BREAK SHARP EDGES .005 TO .010.
 MACHINED FILLET RADI .005 TO .015.
 WELDING SYMBOLS PER AWS A2.4.
 ABBREVIATIONS PER MIL-STD-12.

UNLESS OTHERWISE SPECIFIED:
 DIMENSIONS ARE IN INCHES. DIMENSIONS IN BRACKETS [] ARE IN MILLIMETERS
 TOLERANCES ARE:
 INCHES METRIC ANGLES
 .XX ± .03 .X ± 0.8 ± 1°
 .XXX ± .010 .XX ± 0.25

MATERIAL

FINISH

DO NOT SCALE DRAWING

CONTRACT NO.

APPROVALS		DATE
ORIG	NC	09/22/09
CHK	DV	10/12/09
APP	EP	10/12/09
APP	RA	1/13/14

DYTRAN INSTRUMENTS, INC. MASTER ONLY IF IN RED Chatsworth, CA

TITLE: OUTLINE/INSTALLATION, BIAxIAL ACCELEROMETER, MODEL 3302A

SIZE	CAGE CODE	DWG. NO.	REV
A	2W033	127-3302A	B
SCALE: 1.5:1	SOLIDWORKS	SHEET 1 OF 1	



- BI-AXIAL ACCELEROMETER
- EXCELLENT LINEARITY
- ELECTRICALLY ISOLATED
- HERMETICALLY SEALED

PHYSICAL

	ENGLISH		SI	
Weight, Max	1.05	oz	30	grams
Size	1.05 x 1.208 x .406	Inches	26.67 x 30.68 x 10.31	mm
Connector	3-Pin		3-Pin	
	Thread		5/16-28 UN-2A	
Mounting Provision, Integral Bracket	Ø .31 Thru Hole	Inches	Ø 7.92 Thru Hole	mm
Material	Housing		316 L	
	Connector		304 L	
Element Style	Quartz Shear		Quartz Shear	

PERFORMANCE

Sensitivity, ±5% [1]	10	mV/g	1	mV/m/s ²
Range F.S for ± 5 Volts Output	± 500	g	± 4905	m/s ²
Frequency Range [4]	1 to 10	Hz	1 to 10	Hz
	±5%	10 to 1000	Hz	10 to 1000
	-5% / +15%	1000 to 3000	Hz	1000 to 3000
Resonant Frequency	> 26	kHz	> 26	kHz
Equivalent Electrical Noise Floor	0.007	Grms	0.069	m/s ² rms
Linearity [2]	± 1%	F.S.	± 1%	F.S.
Maximum Transverse sensitivity	5	%	5	%
Strain Sensitivity @ 250µε	0.012	g/µε	0.12	m/s ² /µε

ENVIRONMENTAL

Maximum Vibration	± 600	Gpeak	± 5886	m/s ² peak
Maximum Shock	± 3000	Gpeak	± 29430	m/s ² peak
Temperature Range	-60 to 250	°F	-54 to 121	°C
Seal, Hermetic	Welded/GTM Header		Welded/GTM Header	

ELECTRICAL

Supply Current Range [3]	2 to 20	mA	2 to 20	mA
Compliance Voltage Range	+ 18 to +30	Volts	+ 18 to +30	Volts
Output Impedance, Typ	100	Ω	100	Ω
Bias Voltage	+7 to +9	VDC	+7 to +9	VDC
Discharge Time Constant, Nom	0.3 to 1.5	Sec	0.3 to 1.5	Sec
Output Signal Polarity for Acceleration Along Arrow On The Housing	Positive		Positive	
Electrical Isolation, Case Ground To Mounting Surface	10	GΩ,min	10	GΩ,min

This family also includes:

Model	Sensitivity	Range F.S ± 5 Volts	Max Vibration/Shock	Resonant Frequency

Please, refer to the performance specifications of the products in this family for detailed description

Supplied Accessories:

- 1) Accredited calibration certificate (ISO 17025)
- 2) Adaptor bushing (Ø .250 thru hole), model # 6555A, qty 1
- 3) Adaptor bushing (Ø .188 thru hole), model # 6555A1, qty 1

Notes:

- [1] Measure at 100Hz, 1 Grms per ISA RP 37.2
- [2] Measure using zero-based straight line method, % of F.S. or any lesser range.
- [3] Do not apply power to this system without current limiting, 20 mA MAX. To do so will destroy the IC charge amplifier.
- [4] Frequency response is referenced to nominal sensitivity
- [5] Connector mates with GLENAIR 257-132-3S
- [6] In the interest of constant product improvement, we reserve the right to change specifications without notice

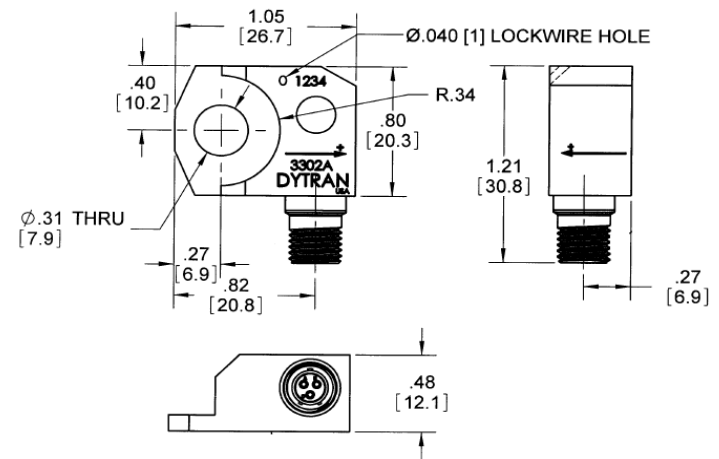
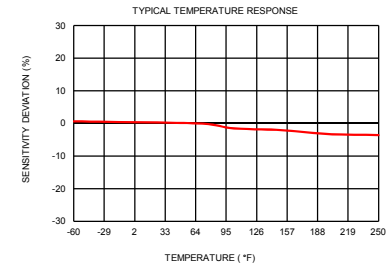
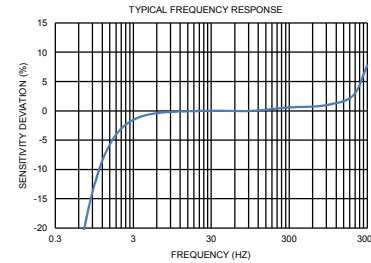

Units on the line drawing are in inches, units in brackets are in millimeters. Refer to 127-3302A for more information.

