

PROPRIETARY AND CONFIDENTIAL

THE INFORMATION CONTAINED IN THIS DRAWING IS THE SOLE PROPERTY OF DYTRAN INSTRUMENTS INC. ANY REPRODUCTION IN PART OR AS A WHOLE WITHOUT THE WRITTEN PERMISSION OF DYTRAN INSTRUMENTS INC. IS PROHIBITED

REVISIONS

REV.	ECN	DESCRIPTION	BY/DATE	CHK	APPR
B	12499	NOTE 2 WEIGHT WAS: 25 GRAMS	JS 02/10/16	LA	LN
C	12594	ADDED NOTE 8, REFORMATTED TO B SIZE	JS 04/05/16	LA	AS

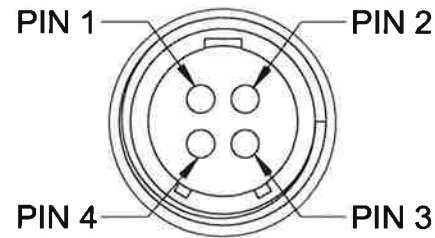

DETAIL A

CONNECTOR PINOUT
 PIN 1 GND RETURN, COMMON
 PIN 2 SIG/PWR AXIS 2 (Y)
 PIN 3 SIG/PWR AXIS 3 (Z)
 PIN 4 SIG/PWR AXIS 1 (X)

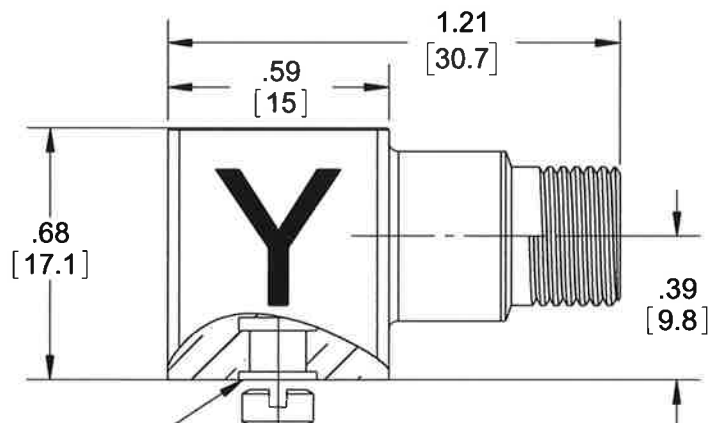
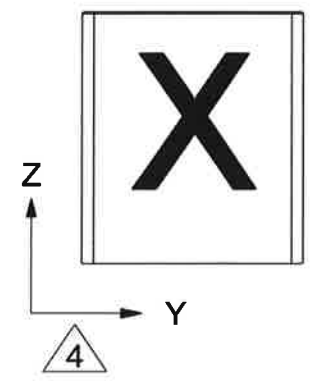
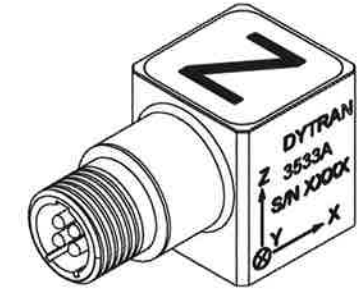
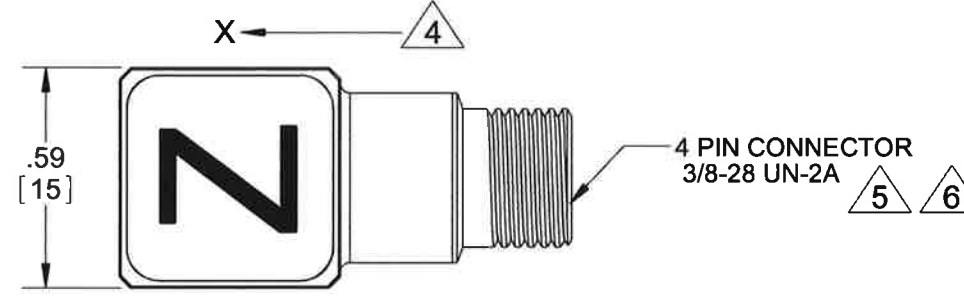

10-32 UNC-2B \downarrow .16
 \square ϕ .21 \downarrow .02
 MODEL 6200
 MTG STUD
 (SUPPLIED)

RECOMMENDED MOUNTING SURFACE:
 PREPARE A SURFACE AT LEAST .600 X .600. SURFACE FLATNESS MUST BE EQUAL OR BETTER THAN .001 TIR. TAP 10-32 UNF-2B X \downarrow .200 MIN.

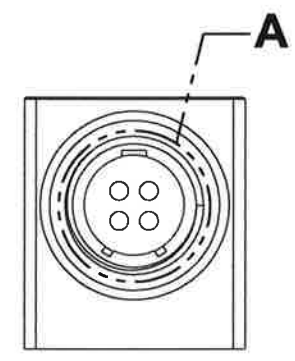

8. MINOR VOIDS, SCARS, SCRATCHES AND MOUNTING BLEMISH/WITNESS MARKS ON EXTERIOR SURFACES ARE ALLOWED DUE TO RESTRAINING AND HANDLING DURING TESTING, TRANSPORT OR PROCESSING THESE APPEAR AS INDICATORS THAT DO NOT AFFECT FORM, FIT OR FUNCTION AS INTENDED BY DESIGN OR APPLICATION

7. RECOMMENDED TORQUE: 10-12 LB-IN

- 6 MATES WITH DYTRAN CABLE MODEL 6669AXX. (XX = LENGTH IN FEET)
- 5 MATING CONNECTOR: GLENAIR P/N: 800-006-16-Z1-6-4SN
- 4 ARROWS INDICATE ACCELERATION DIRECTION FOR POSITIVE OUTPUT.
- 3. HOUSING AND CONNECTOR MATERIAL: 304L
- 2. WEIGHT: 28 GRAMS MAX.
- 1. ENVIRONMENTAL SEAL: HERMETIC

NOTES: UNLESS OTHERWISE SPECIFIED

UNLESS OTHERWISE SPECIFIED: INTERPRET DIM & TOL PER ASME Y14.5M - 1994. REMOVE BURRS. COUNTERSINK INTERNAL THDS 90° TO MAJOR DIA. CHAM EXT THDS 45° TO MINOR DIA. THD LENGTHS AND DEPTHS ARE FOR MIN FULL THDS. DIMENSIONS APPLY AFTER FINISHING. ALL MACHINED SURFACES. TOTAL RUNOUT WITHIN .005. BREAK SHARP EDGES .005 TO .010. MACHINED FILLET RADII .005 TO .015. WELDING SYMBOLS PER AWS A2.4. ABBREVIATIONS PER MIL-STD-12.	UNLESS OTHERWISE SPECIFIED: DIMENSIONS ARE IN INCHES. DIMENSIONS IN BRACKETS [] ARE IN MILLIMETERS TOLERANCES ARE: DECIMALS METRIC ANGLES .XX ± .03 .X ± 0.8 ± 1° .XXX ± .010 .XX ± 0.25				MASTER COPY ONLY IN RED			
	APPROVALS DATE ORIG RT 11/26/13 CHK MH 11/09/14 APP RT 11/09/14						TITLE: OUTLINE/INSTALLATION DRAWING 3533A	
	DO NOT SCALE DRAWING		THIRD ANGLE PROJECTION USA		SIZE B	CAGE CODE 2W033	DWG NO 127-3533A	REV C
			SCALE: 2:1		SHEET 1 OF 1			

3533A	PERFORMANCE SPECIFICATION	Doc No PS3533A
	Accelerometer, Triaxial, IEPE	REV C, EGN 15062, 05/21/19



- GROUND ISOLATED
- HERMETICALLY SEALED
- STUD MOUNT
- TEDS FEATURE

PHYSICAL

Weight, Max
Mounting
Connector [1]

Housing

Sensing Element

	ENGLISH		SI	
Type	1.0	oz	28	grams
Material	10-32 UNC-2B		10-32 UNC-2B	
Material	4 pin Mighty Mouse		4 pin Mighty Mouse	
Isolation	304L		304L	
Material Element	304L		304L	
	Case Isolated		Case Isolated	
	Piezoelectric		Piezoelectric	
	Shear		Shear	

PERFORMANCE

Sensitivity, ±5% [2]
Acceleration Range, ±
Frequency Range, ±5%
Frequency Range, ±15%
Frequency Range, ±3dB
Resonance Frequency
Linearity [3]
Transverse Sensitivity, Max
Noise floor
Spectral Noise

	ENGLISH		SI	
Sensitivity, ±5% [2]	5	mV/g	0.51	mV/m/s ²
Acceleration Range, ±	1000	Gpeak	9810	m/s ² peak
Frequency Range, ±5%	3.3-1000	Hz	3.3-1000	Hz
Frequency Range, ±15%	2.2-3000	Hz	2.2-3000	Hz
Frequency Range, ±3dB	1.1-6000	Hz	1.1-6000	Hz
Resonance Frequency	>50	kHz	>50	kHz
Linearity [3]	1	%F.S.	1	%F.S.
Transverse Sensitivity, Max	6	%	6	%
Noise floor	0.007	Grms	0.069	m/s ² rms
Spectral Noise	1Hz	1000	9810	µm/s ² rms/sqr(Hz)
	10Hz	500	4905	µm/s ² rms/sqr(Hz)
	100Hz	100	981	µm/s ² rms/sqr(Hz)
	1000Hz	60	589	µm/s ² rms/sqr(Hz)
	10000Hz	50	491	µm/s ² rms/sqr(Hz)

ELECTRICAL

Supply Current Range [4]
Compliance Voltage Range
Output Impedance, Typ.
Output Bias Voltage
Discharge Time Constant

	ENGLISH		SI	
Supply Current Range [4]	2 to 20	mA	2 to 20	mA
Compliance Voltage Range	+18 to +30	VDC	+18 to +30	VDC
Output Impedance, Typ.	100	Ω	100	Ω
Output Bias Voltage	+7 to +13	VDC	+7 to +13	VDC
Discharge Time Constant	0.15 to 0.5	Sec	0.15 to 0.5	Sec

ENVIRONMENTAL

Shock Max
Vibration Max
Operating Temperature
Seal
Base Strain Sensitivity
TEDS

	ENGLISH		SI	
Shock Max	5000	g pk	49050	m/s ²
Vibration Max	1500	g pk	14715	m/s ²
Operating Temperature	-60 to +250	°F	-51 to +121	°C
Seal	Hermetic		Hermetic	
Base Strain Sensitivity	0.002	g/µε	0.02	m/s ² /µε
TEDS	IEEE 1451.4		IEEE 1451.4	

This family also includes:

Model	Sensitivity (mV/g)	Range (Gpeak)	Noise Resolution (Grms)	Temp Range (°F)	Time Constant (sec)

Refer to the performance specifications of the products in this family for detailed description.

Supplied Accessories:

- 1) Accredited Calibration Certificate (ISO 17025).
- 2) Mounting Stud Model 6200 Supplied, QTY 1

Notes:

- [1] Mates with Glenair connector 800-006-16-Z1-6-4SN. Dytran cable model 6669AXX.
 - [2] Measured At 100 Hz, 1 Grms per ISA RP 37.2.
 - [3] Measured using zero-based best straight-line method.
 - [4] Do not apply power to this device without current limiting, 20mA Max, to do so will destroy the integral IC amplifier.
 - [5] In the interest of constant product improvement, we reserve the rights to change the specifications without notice.
- It is the customer's responsibility to validate that a particular product with the properties described in the product specification is suitable for use in a particular application. Parameters provided in datasheets and / or specifications may vary in different applications and performance may vary overtime. All operating parameters, including typical parameters, must be validated for each customer application by the customer's technical experts.

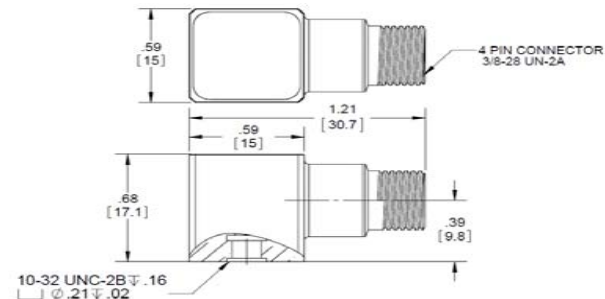
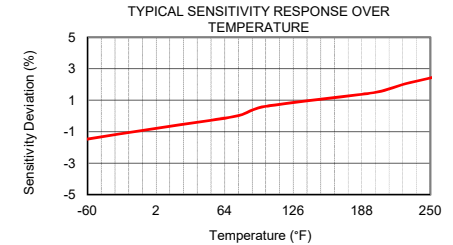
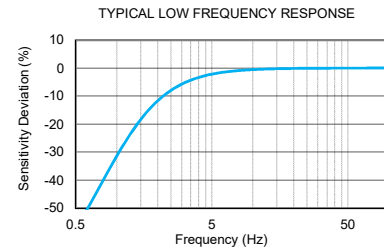

Units on the line drawing are in inches, units in brackets are in millimeters. Refer to 127-3533A for more information.



21592 Marilla Street, Chatsworth, California 91311 Phone: 818.700.7818 Fax:818.700.7880 www.dytran.com For permission to reprint this content, please contact info@dytran.com