

PROPRIETARY AND CONFIDENTIAL

THE INFORMATION CONTAINED IN THIS DRAWING IS THE SOLE PROPERTY OF DYTRAN INSTRUMENTS INC. ANY REPRODUCTION IN PART OR AS A WHOLE WITHOUT THE WRITTEN PERMISSION OF DYTRAN INSTRUMENTS INC. IS PROHIBITED

REVISIONS

REV	ECN	DESCRIPTION	BY/DATE	CHK	APPR
A	11107	INITIAL RELEASE	JS 06/23/14	Em	JZ

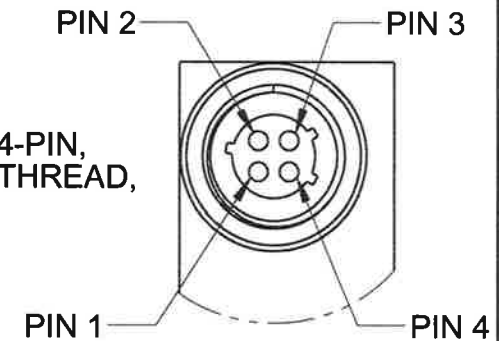
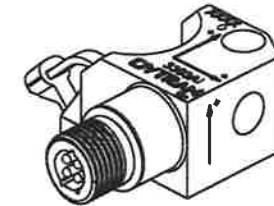
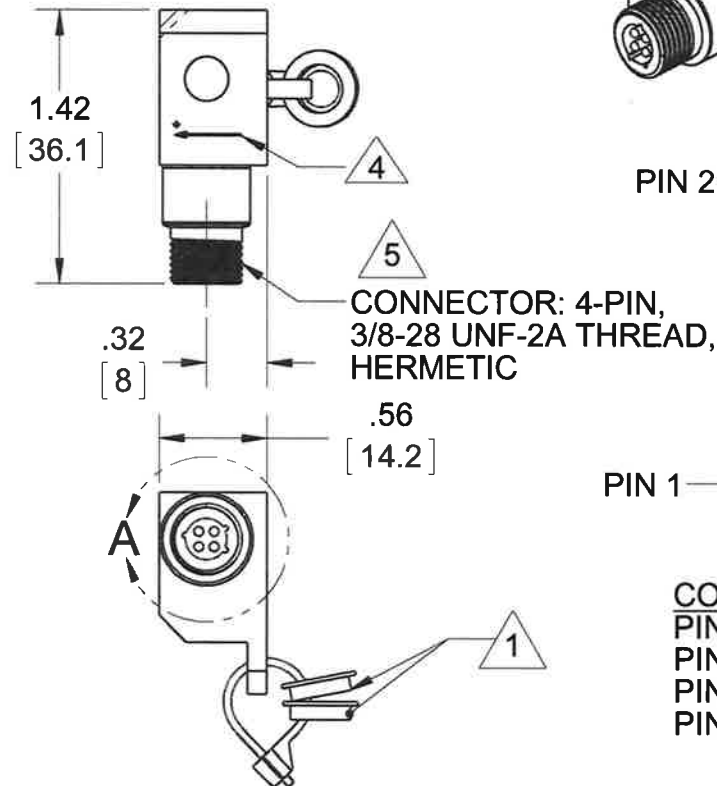
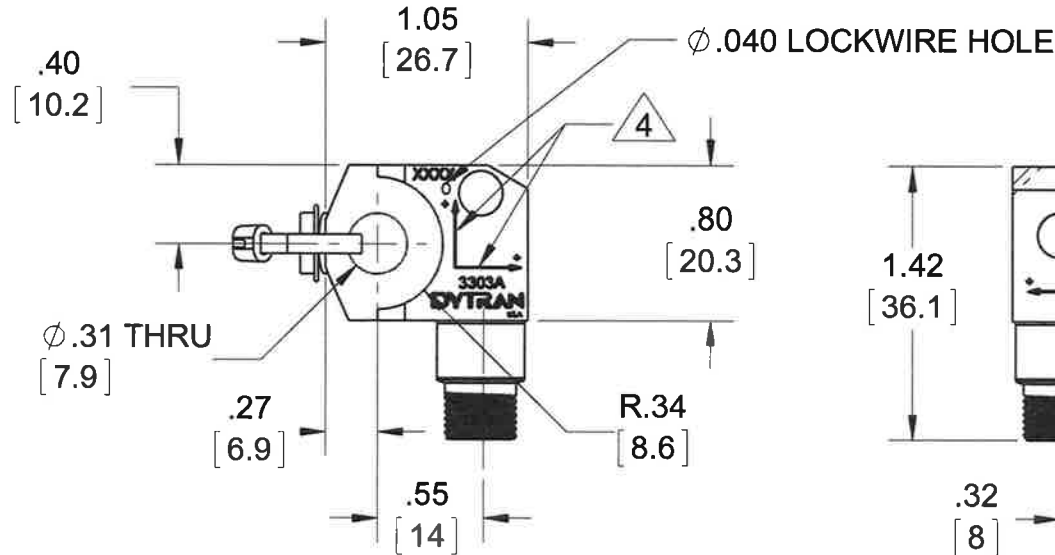

DETAIL A

CONNECTOR PINOUT
 PIN 1 SIG/PWR AXIS 1
 PIN 2 COMMON GND RTN
 PIN 3 SIG/PWR AXIS 3
 PIN 4 SIG/PWR AXIS 2

- 5 MATING CONNECTOR: GLENAIR 800-006-06Z16-4SX
4. ARROWS SHOW DIRECTION OF ACCELERATIONS FOR POSITIVE-GOING OUTPUT SIGNAL.
3. WEIGHT: 30 GRAMS MAX
2. HOUSING & CONNECTOR MATERIAL: 300 SERIES STAINLESS STEEL.
- 1 ADAPTER BUSHINGS: 6555A (ϕ .250, [6.35]), AND 6555A1 (ϕ .188, [4.77]), 1 EA. SUPPLIED

NOTES: UNLESS OTHERWISE SPECIFIED.

CONTRACT NO.

3303A	
USED ON	NEXT ASSY
APPLICATION	
THIRD ANGLE PROJECTION USA	
<p>UNLESS OTHERWISE SPECIFIED: INTERPRET DIM & TOL PER ASME Y14.5M - 1994. REMOVE BURRS. COUNTERSINK INTERNAL THDS 90° TO MAJOR DIA. CHAM EXT THDS 45° TO MINOR DIA. THD LENGTHS AND DEPTHS ARE FOR MIN FULL THDS. THDS PER MIL-S-7742. DIMENSIONS APPLY AFTER FINISHING.</p> <p>ALL MACHINED SURFACES. TOTAL RUNOUT WITHIN .005. BREAK SHARP EDGES .005 TO .010. MACHINED FILLET RADII .005 TO .015. WELDING SYMBOLS PER AWS A2.4. ABBREVIATIONS PER MIL-STD-12.</p>	

UNLESS OTHERWISE SPECIFIED: DIMENSIONS ARE IN INCHES. DIMENSIONS IN BRACKETS [] ARE IN MILLIMETERS. TOLERANCES ARE: INCHES METRIC ANGLES XX \pm .03 .X \pm 0.8 \pm 1° XXX \pm .010 .XX \pm 0.25	
MATERIAL	
FINISH	
DO NOT SCALE DRAWING	

APPROVALS		DATE
ORIG	NC	05/14/14
CHK	Em	7/1/14
APP	JZ	8/8/14
APP		

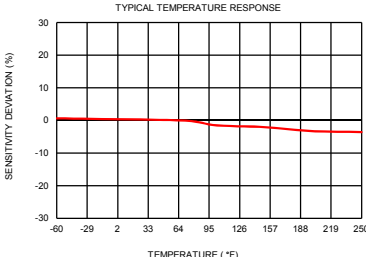
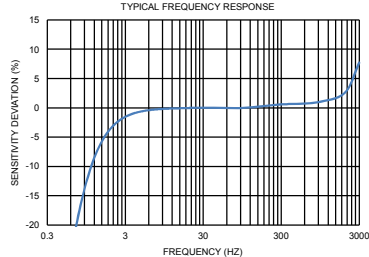
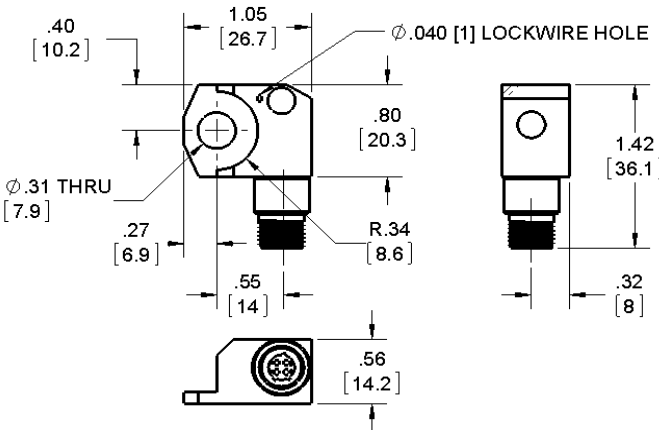

TITLE: OUTLINE/INSTALLATION DRAWING TRIAxIAL ACCELEROMETER, 3303A			
SIZE A	CAGE CODE 2W033	DWG. NO. 127-3303A	REV A
SCALE: NONE		SOLIDWORKS	SHEET 1 OF 1

Model Number 3303A		PERFORMANCE SPECIFICATION				DOC NO PS3303A																																							
		IEPE QUARTZ SHEAR TRI-AXIAL ACCELEROMETER				REV A, ECN 11107, 06/25/14																																							
		<ul style="list-style-type: none">• TRI-AXIAL ACCELEROMETER• EXCELLENT LINEARITY• ELECTRICALLY ISOLATED• HERMETICALLY SEALED				This family also includes: <table><tr><th>Model</th><th>Sensitivity</th><th>Range F.S ± 5 Volts</th><th>Max Vibration/Shock</th><th>Resonant Frequency</th></tr><tr><td></td><td></td><td></td><td></td><td></td></tr><tr><td></td><td></td><td></td><td></td><td></td></tr><tr><td></td><td></td><td></td><td></td><td></td></tr></table>		Model	Sensitivity	Range F.S ± 5 Volts	Max Vibration/Shock	Resonant Frequency																																	
Model	Sensitivity	Range F.S ± 5 Volts	Max Vibration/Shock	Resonant Frequency																																									
PHYSICAL Weight, Max Size Length x Width x Height Connector Type Thread Mounting Provision, Integral Bracket Material Housing Connector Element Style		<table><tr><th>ENGLISH</th><th></th><th>SI</th></tr><tr><td>1.05</td><td>oz</td><td>30</td></tr><tr><td>1.05 x 1.42 x .56</td><td>Inches</td><td>26.70 x 36.1 x 14.20</td></tr><tr><td>4-Pin</td><td></td><td>4-Pin</td></tr><tr><td>3/8-28 UN-2A</td><td></td><td>3/8-28 UN-2A</td></tr><tr><td>Ø .31 Thru Hole</td><td>Inches</td><td>Ø 7.92 Thru Hole</td></tr><tr><td>316 L</td><td></td><td>316 L</td></tr><tr><td>304 L</td><td></td><td>304 L</td></tr><tr><td>Quartz Shear</td><td></td><td>Quartz Shear</td></tr></table>		ENGLISH		SI	1.05	oz	30	1.05 x 1.42 x .56	Inches	26.70 x 36.1 x 14.20	4-Pin		4-Pin	3/8-28 UN-2A		3/8-28 UN-2A	Ø .31 Thru Hole	Inches	Ø 7.92 Thru Hole	316 L		316 L	304 L		304 L	Quartz Shear		Quartz Shear															
ENGLISH		SI																																											
1.05	oz	30																																											
1.05 x 1.42 x .56	Inches	26.70 x 36.1 x 14.20																																											
4-Pin		4-Pin																																											
3/8-28 UN-2A		3/8-28 UN-2A																																											
Ø .31 Thru Hole	Inches	Ø 7.92 Thru Hole																																											
316 L		316 L																																											
304 L		304 L																																											
Quartz Shear		Quartz Shear																																											
PERFORMANCE Sensitivity, ±5% [1] Range F.S for ± 5 Volts Output Frequency Range [4] Resonant Frequency Equivalent Electrical Noise Floor Linearity [2] Maximum Transverse sensitivity Strain Sensitivity @ 250µε		<table><tr><td>10</td><td>mV/g</td><td>1</td><td>mV/m/s²</td></tr><tr><td>± 500</td><td>g</td><td>± 4905</td><td>m/s²</td></tr><tr><td>1 to 10</td><td>Hz</td><td>1 to 10</td><td>Hz</td></tr><tr><td>10 to 1000</td><td>Hz</td><td>10 to 1000</td><td>Hz</td></tr><tr><td>1000 to 3000</td><td>Hz</td><td>1000 to 3000</td><td>Hz</td></tr><tr><td>> 26</td><td>kHz</td><td>> 26</td><td>kHz</td></tr><tr><td>0.007</td><td>Grms</td><td>0.069</td><td>m/s² rms</td></tr><tr><td>± 1%</td><td>F.S.</td><td>± 1%</td><td>F.S.</td></tr><tr><td>5</td><td>%</td><td>5</td><td>%</td></tr><tr><td>0.012</td><td>g/µε</td><td>0.12</td><td>m/s²/µε</td></tr></table>		10	mV/g	1	mV/m/s ²	± 500	g	± 4905	m/s ²	1 to 10	Hz	1 to 10	Hz	10 to 1000	Hz	10 to 1000	Hz	1000 to 3000	Hz	1000 to 3000	Hz	> 26	kHz	> 26	kHz	0.007	Grms	0.069	m/s ² rms	± 1%	F.S.	± 1%	F.S.	5	%	5	%	0.012	g/µε	0.12	m/s ² /µε		
10	mV/g	1	mV/m/s ²																																										
± 500	g	± 4905	m/s ²																																										
1 to 10	Hz	1 to 10	Hz																																										
10 to 1000	Hz	10 to 1000	Hz																																										
1000 to 3000	Hz	1000 to 3000	Hz																																										
> 26	kHz	> 26	kHz																																										
0.007	Grms	0.069	m/s ² rms																																										
± 1%	F.S.	± 1%	F.S.																																										
5	%	5	%																																										
0.012	g/µε	0.12	m/s ² /µε																																										
ENVIRONMENTAL Maximum Vibration Maximum Shock Temperature Range Seal, Hermetic		<table><tr><td>± 600</td><td>Gpeak</td><td>± 5886</td><td>m/s² peak</td></tr><tr><td>± 3000</td><td>Gpeak</td><td>± 29430</td><td>m/s² peak</td></tr><tr><td>-60 to 250</td><td>°F</td><td>-54 to 121</td><td>°C</td></tr><tr><td>Welded/GTM Header</td><td></td><td>Welded/GTM Header</td><td></td></tr></table>		± 600	Gpeak	± 5886	m/s ² peak	± 3000	Gpeak	± 29430	m/s ² peak	-60 to 250	°F	-54 to 121	°C	Welded/GTM Header		Welded/GTM Header																											
± 600	Gpeak	± 5886	m/s ² peak																																										
± 3000	Gpeak	± 29430	m/s ² peak																																										
-60 to 250	°F	-54 to 121	°C																																										
Welded/GTM Header		Welded/GTM Header																																											
ELECTRICAL Supply Current Range [3] Compliance Voltage Range Output Impedance, Typ Bias Voltage Discharge Time Constant, Nom Output Signal Polarity for Acceleration Along Arrow On The Housing Electrical Isolation, Case Ground To Mounting Surface		<table><tr><td>2 to 20</td><td>mA</td><td>2 to 20</td><td>mA</td></tr><tr><td>+ 18 to +30</td><td>Volts</td><td>+ 18 to +30</td><td>Volts</td></tr><tr><td>100</td><td>Ω</td><td>100</td><td>Ω</td></tr><tr><td>+7 to +9</td><td>VDC</td><td>+7 to +9</td><td>VDC</td></tr><tr><td>0.3 to 1.5</td><td>Sec</td><td>0.3 to 1.5</td><td>Sec</td></tr><tr><td>Positive</td><td></td><td>Positive</td><td></td></tr><tr><td>10</td><td>GΩ,min</td><td>10</td><td>GΩ,min</td></tr></table>		2 to 20	mA	2 to 20	mA	+ 18 to +30	Volts	+ 18 to +30	Volts	100	Ω	100	Ω	+7 to +9	VDC	+7 to +9	VDC	0.3 to 1.5	Sec	0.3 to 1.5	Sec	Positive		Positive		10	GΩ,min	10	GΩ,min														
2 to 20	mA	2 to 20	mA																																										
+ 18 to +30	Volts	+ 18 to +30	Volts																																										
100	Ω	100	Ω																																										
+7 to +9	VDC	+7 to +9	VDC																																										
0.3 to 1.5	Sec	0.3 to 1.5	Sec																																										
Positive		Positive																																											
10	GΩ,min	10	GΩ,min																																										
		<p>Please, refer to the performance specifications of the products in this family for detailed description</p> <p>Supplied Accessories:</p> <p>1) Accredited calibration certificate (ISO 17025)</p> <p>2) Adaptor bushing (Ø .250 thru hole), model # 6555A, qty 1</p> <p>3) Adaptor bushing (Ø .188 thru hole), model # 6555A1, qty 1</p> <p>Notes:</p> <p>[1] Measured at 100Hz, 1 Grms per ISA RP 37.2</p> <p>[2] Measured using zero-based straight line method, % of F.S. or any lesser range.</p> <p>[3] Do not apply power to this system without current limiting, 20 mA MAX. To do so will destroy the IC charge amplifier.</p> <p>[4] Frequency response is referenced to nominal sensitivity</p> <p>[5] Connector mates with GLENAIR 800-006-06Z16-4SX</p> <div></div> 																																											
		Units on the line drawing are in inches, units in brackets are in millimeters. Refer to 127-3303A for more information.																																											



21592 Marilla Street, Chatsworth, California 91311 Phone: 818.700.7818 Fax:818.700.7880 www.dytran.com
For permission to reprint this content, please contact info@dytran.com