

PROPRIETARY AND CONFIDENTIAL

THE INFORMATION CONTAINED IN THIS DRAWING IS THE SOLE PROPERTY OF DYTRAN INSTRUMENTS INC. ANY REPRODUCTION IN PART OR AS A WHOLE WITHOUT THE WRITTEN PERMISSION OF DYTRAN INSTRUMENTS INC. IS PROHIBITED

REVISIONS

REV	ECN	DESCRIPTION	BY/DATE	CHK	APPR
D	11957	NOTE 4 WAS: WEIGHT: 5 GRAMS MAX	JS 05/07/15	LA	DV
E	13509	NOTE 5: CONNECTOR MATERIAL: WAS: UNS K94610,ASTM F-15 IS: ALLOY X-750	AM 6/14/2017	W	AS

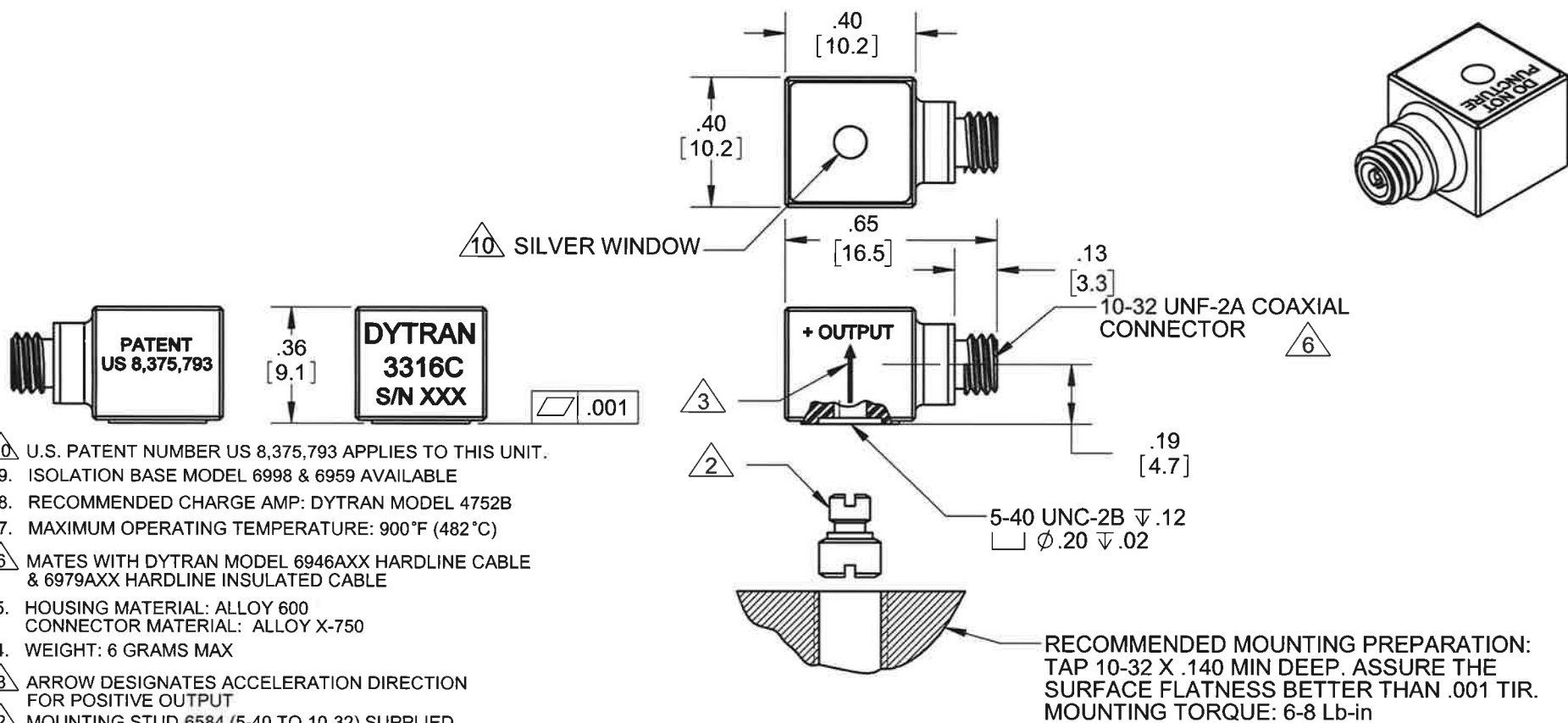

10 U.S. PATENT NUMBER US 8,375,793 APPLIES TO THIS UNIT.

- 9. ISOLATION BASE MODEL 6998 & 6959 AVAILABLE
- 8. RECOMMENDED CHARGE AMP: DYTRAN MODEL 4752B
- 7. MAXIMUM OPERATING TEMPERATURE: 900°F (482°C)

6 MATES WITH DYTRAN MODEL 6946AXX HARDLINE CABLE & 6979AXX HARDLINE INSULATED CABLE

5. HOUSING MATERIAL: ALLOY 600
CONNECTOR MATERIAL: ALLOY X-750

4. WEIGHT: 6 GRAMS MAX

3 ARROW DESIGNATES ACCELERATION DIRECTION FOR POSITIVE OUTPUT

2 MOUNTING STUD 6584 (5-40 TO 10-32) SUPPLIED

1. SENSITIVITY: 1 TO 2 pC/g

NOTES: UNLESS OTHERWISE SPECIFIED

USED ON	NEXT ASSY
APPLICATION	
THIRD ANGLE PROJECTION USA	
<p>UNLESS OTHERWISE SPECIFIED: INTERPRET DIM & TOL PER ASME Y14.5M - 1994. REMOVE BURRS. COUNTERSINK INTERNAL THDS 90° TO MAJOR DIA. CHAM EXT THDS 45° TO MINOR DIA. THD LENGTHS AND DEPTHS ARE FOR MIN FULL THDS. THDS PER MIL-S-7742. DIMENSIONS APPLY AFTER FINISHING.</p> <p>ALL MACHINED SURFACES: TOTAL RUNOUT WITHIN .005. BREAK SHARP EDGES .005 TO .010. MACHINED FILLET RADII .005 TO .015. WELDING SYMBOLS PER AWS A2.4. ABBREVIATIONS PER MIL-STD-12.</p>	

UNLESS OTHERWISE SPECIFIED: DIMENSIONS ARE IN INCHES. DIMENSIONS IN BRACKETS [] ARE IN MILLIMETERS. TOLERANCES ARE: INCHES METRIC ANGLES .XX ±.03 X ±0.8 ±1° .XXX±.010 .XX ±0.25		
MATERIAL	APPROVALS	DATE
FINISH	ORIG DV	09/10/08
	CHK DV	12/06/11
	APP ANS	12/06/11
DO NOT SCALE DRAWING	APP	

CONTRACT NO.



TITLE:
**OUTLINE/INSTALLATION
DRAWING, 3316C SERIES**

SIZE A	CAGE CODE 2W033	DWG. NO. 127-3316C	REV E
SCALE: NONE		SOLIDWORKS	SHEET 1 OF 1

Model Number 3316C	PERFORMANCE SPECIFICATION	DOC NO PS3316C
SINGLE AXIS CHARGE MODE ACCELEROMETER		REV H, ECN 14095, 03/14/18

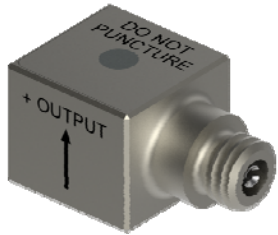

- MINIATURE SIZE
- HERMETICALLY SEALED
- HIGH TEMPERATURE OPERATION

	ENGLISH		SI	
PHYSICAL				
Weight, Max	0.21	oz	6.0	grams
Size	Square x Height .40 x .36	Inches	10.16 x 9.10	mm
Connector [3]	Type 10-32 Coaxial		10-32 Coaxial	
Mounting Provision : Tapped Hole	5-40 UNC-2B		5-40 UNC-2B	
Material	Housing Alloy 600		Alloy 600	
Connector	Alloy X-750		Alloy X-750	
Element Style	Material Single Crystal		Single Crystal	
	Type Planar Shear		Planar Shear	

	ENGLISH		SI	
PERFORMANCE				
Sensitivity [1]	1 to 2	pC/g	0.10 to 0.20	pC/m/s ²
Range F.S for ± 5 Volts Output	[9]	G's	[9]	m/s ²
Frequency Range, ±10%	[4] to 10000	Hz	[4] to 10000	Hz
Resonant Frequency	> 45	kHz	> 45	kHz
Capacitance	120	pF	120	pF
Linearity [2]	± 1%	% F.S.	± 1%	% F.S.
Phase Response (±5°)	[4] to 3000	Hz	[4] to 3000	Hz
Maximum Transverse Sensitivity	5	%	5	%
Strain Sensitivity, Max	0.003	g/με	0.03	m/s ² /με
Insulation resistance, (Connector pin to case)	at 75 °F > 5	MΩ	at 75 °F > 5	MΩ
	at 900 °F > 0.25	MΩ	at 900 °F > 0.25	MΩ
Coefficient of Thermal Sensitivity	0.02	%F	0.02	%F
Ground Isolation	Case Ground		Case Ground	

	ENGLISH		SI	
ENVIRONMENTAL				
Maximum Vibration	±6000	G, peak	±5886	m/s ² , peak
Maximum Shock	±10000	G, peak	±49050	m/s ² , peak
Temperature Range	-60 to+900	°F	-51 to+482	°C
Seal	Hermetic		Hermetic	
Radiation Exposure Limit (Integrated Neutron Flux)	1.0E+10	N/cm ²	1.0E+10	N/cm ²
Radiation Exposure Limit (Integrated Gamma Flux)	1.0E+08	rad	1.0E+08	rad

This family also includes:

Model	Sensitivity (pC/g)	Output Polarity	Temperature (°F)
3316C1	1 to 2	Negative when mounted on its base	-60 to+900

Refer to the performance specifications of the products in this family for detailed description.

Supplied Accessories:

- 1) Accredited calibration certificate (ISO 17025)
- 2) Model 6584 mounting stud (5-40 to 10-32), qty 1

Notes:

- [1] Measured at 100Hz, 1 Grms per ISA RP 37.2
- [2] Measured using zero-based straight line method, % of F.S. or any lesser range.
- [3] Mates with Dytran cable 6946AXX hardline cable and 6979AXX hardline insulated cable.
- [4] Low frequency response and phase response are a function of the discharge time constant of the charge amplifier used. See graph below for example.
- [5] In the interest of constant product improvement, we reserve the right to change specifications without notice.
- [6] Recommended charge amplifier: Dytran model 4754B, Series.
- [7] Isolation mounting base model 6959 (triaxial) and 6998 (uniaxial) are available.
- [8] U.S. Patent number US 8,375,793 B2 applies to this unit.
- [9] This parameter depends on the gain settings of the charge amplifier used.

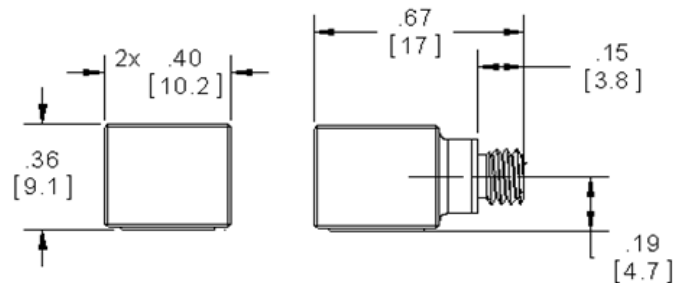
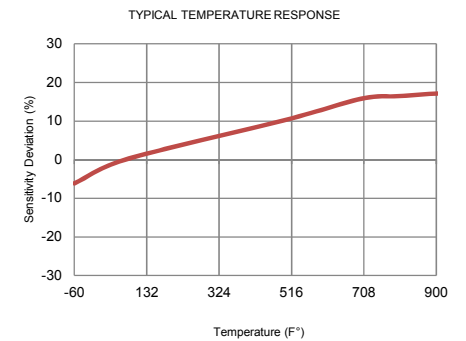
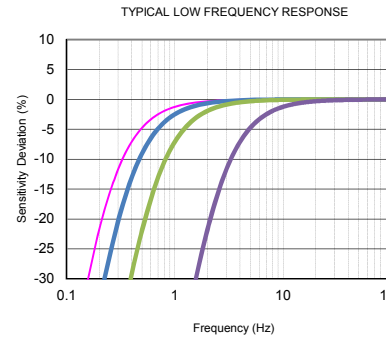

Units on the line drawing are in inches, units in brackets are in millimeters. Refer to 127-3316C for more information.



21592 Marilla Street, Chatsworth, California 91311 Phone: 818.700.7818 Fax:818.700.7880 www.dytran.com
For permission to reprint this content, please contact info@dytran.com