

ACTUAL SIZE

CONNECTOR MATES WITH DYTRAN CABLE 6811AXX $\triangle 3$

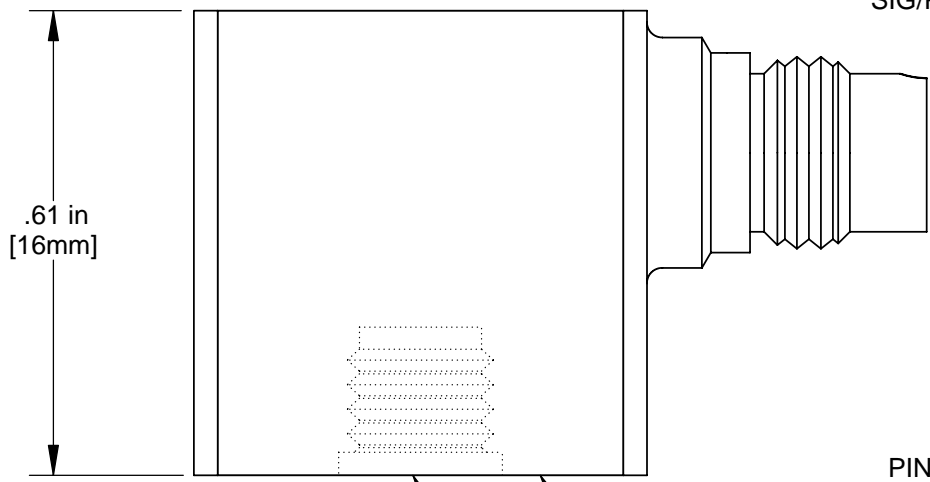

PIN 4 SIG/PWR AXIS 1 (X)

PIN 1 GND RETURN, COMMON

PIN 3 SIG/PWR AXIS 3 (Z)

3 (+Z) AXIS

PIN 2 SIG/PWR AXIS 2 (Y)

TAPPED HOLE 10-32 X .150 DEEP

MOUNTING SURFACE

5. MOUNTING SCREW (10-32 UNC-2B) MODEL 6200 ,PROVIDED

4. WEIGHT = 10 GRAMS

$\triangle 3$ XX = CABLE LENGTH IN FEET

2. + SIGNS INDICATE SENSITIVE AXIS AND DIRECTION OF INPUT ACCELERATION FOR POSITIVE GOING OUTPUT SIGNAL.

1. HOUSING MATERIAL TITANIUM 6AL-4V

EXCEPT AS OTHERWISE NOTED

ALL DIMENSIONS IN INCHES TOLERANCE: .XX = $\pm .01$

DYTRAN		INSTRUMENTS, INC.		CHATSWORTH, CA	
SCALE	4:1	REV	-	DATE	-
DATE	9/3/2004	PART NO.	MODEL 3093M8		
DRAWN	P. Casucci	CHECKED	R.A.		
APPROVED		NEXT ASSEMBLY	USED ON	3093M8	
TITLE			DWG NO.		
OUTLINE / INSTALLATION DRAWING			127-3093M8		
MODEL 3093M8			SHEET 1 OF 1		

Model Number	PERFORMANCE SPECIFICATION			DOC NO
3093M8	Accelerometer, Triaxial, IEPE			PS3093M8
				REV A, ECN 13104, 11/16/16



- HIGH SENSITIVITY
- HERMETICALLY SEALED
- STUD MOUNTED
- TEDS FUNCTIONALITY

PHYSICAL

	ENGLISH		SI	
Weight	0.4	oz	10.0	grams
Mounting Provision	10-32 Stud		10-32 Stud	
Connector [1]	4-pin		4-pin	
Housing	Type			
	Material	Titanium Alloy	Titanium Alloy	
Sensing Element	Isolation	Case Isolated	Case Isolated	
	Material	Ceramic	Ceramic	
Mode	Shear		Shear	

PERFORMANCE

Sensitivity, +15/-10% [2]	100	mV/g	10.2	mV/m/s ²
Acceleration Range	50	Gpeak	491	m/s ² peak
Frequency Range, ±10%	2-5000	Hz	2-5000	Hz
Resonance Frequency	> 30	kHz	> 30	kHz
Linearity [3]	1	%F.S.	1	%F.S.
Transverse Sensitivity, Max.	5	%	5	%
Noise floor	0.0007	Grms	0.007	m/s ² rms

ELECTRICAL

Supply Current Range [4]	2 to 20	mA	2 to 20	mA
Compliance Voltage Range	+18 to +30	VDC	+18 to +30	VDC
Output Impedance, Typ.	100	Ω	100	Ω
Output Bias Voltage	+11 to +13	VDC	+11 to +13	VDC
Discharge Time Constant	0.5 to 1.5	sec	0.5 to 1.5	sec

ENVIRONMENTAL

Shock Max	7000	g pk	68670	m/s ²
Vibration Max	3000	g pk	29430	m/s ²
Operating Temperature	-60 to +225	°F	-51 to +107	°C
TEDS Operating Range	-60 to +185	°F	-51 to 85	°C
Seal	Hermetic		Hermetic	
TEDS Feature	IEEE 1451.4		IEEE 1451.4	

This family also includes:

Model	Sensitivity (mV/g)	Range (Gpeak)	Resolution (Grms)	Oper. Temp(°F)	TC

Refer to performance specifications of the products in this family for detailed description.

Supplied Accessories:

- 1) Model 6200 Mounting Screw
- 2) Accredited Calibration Certificate (ISO 17025)

Notes:

- [1] Glass to Metal seal connector. Mates with Dytran cable Model 6811AXX (XX=length in feet)
- [2] Measured At 100 Hz, 1 Grms per ISA RP 37.2
- [3] Linearity is % of specified full scale (or any less full-scale range), zero-based best fit straight line method.
- [4] Do not apply power to this device without current limiting, 20mA Max. To do so will destroy the integral IC amplifier

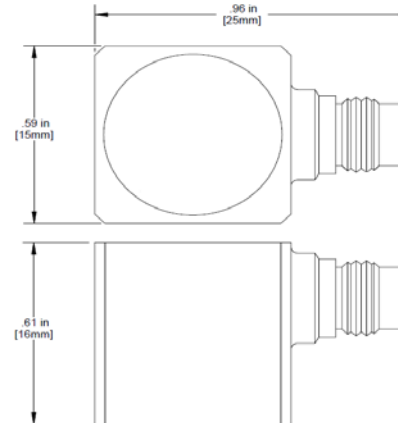
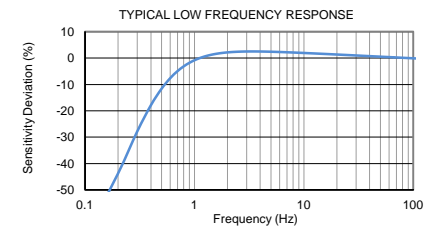
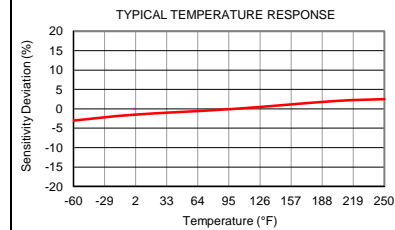

Units on the line drawing are in inches, units in brackets are in millimeters. Refer to 127-3093M8 for more information.



21592 Marilla Street, Chatsworth, California 91311 Phone: 818.700.7818 Fax: 818.700.7880 www.dytran.com
For permission to reprint this content, please contact info@dytran.com