

PROPRIETARY AND CONFIDENTIAL

THE INFORMATION CONTAINED IN THIS DRAWING IS THE SOLE PROPERTY OF DYTRAN INSTRUMENTS INC. ANY REPRODUCTION IN PART OR AS A WHOLE WITHOUT THE WRITTEN PERMISSION OF DYTRAN INSTRUMENTS INC. IS PROHIBITED

REVISIONS

REV	ECN	DESCRIPTION	BY/DATE	CHK	APPR
A	13142	REDRAWN IN SOLIDWORKS	RA 11/30/16	LA	LW

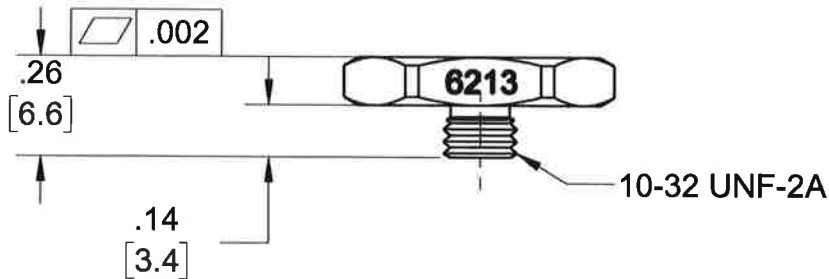
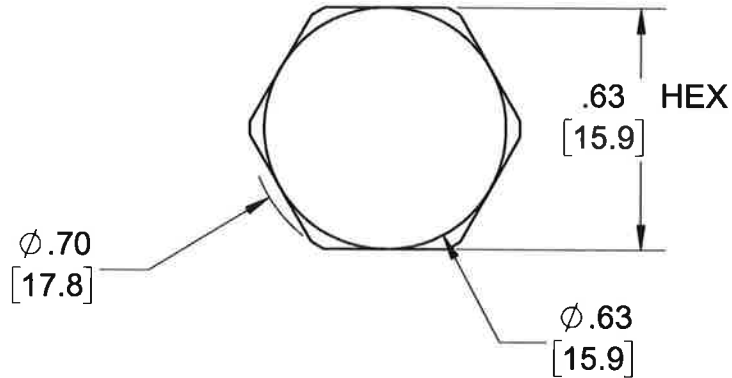

1. MATERIAL: 300 SERIES SS

NOTES: UNLESS OTHERWISE SPECIFIED

CONTRACT NO.



MASTER
ONLY IF IN RED
Chatsworth, CA

TITLE:
**OUTLINE INSTALLATION
DRAWING, 6213**

APPROVALS		DATE
ORIG	RA	04/11/01
CHK	NC	04/11/01
APP	NC	04/11/01
APP		

SIZE	CAGE CODE	DWG. NO.	REV
A	2W033	127-6213	A
SCALE: NONE		SOLIDWORKS	SHEET 1 OF 1

UNLESS OTHERWISE SPECIFIED:
INTERPRET DIM & TOL PER ASME Y14.5M - 1994.
REMOVE BURRS.
COUNTERSINK INTERNAL THDS 90° TO MAJOR DIA.
CHAM EXT THDS 45° TO MINOR DIA. THD LENGTHS AND DEPTHS ARE FOR MIN FULL THDS.
THDS PER MIL-S-7742.
DIMENSIONS APPLY AFTER FINISHING.

UNLESS OTHERWISE SPECIFIED:
DIMENSIONS ARE IN INCHES. DIMENSIONS IN BRACKETS [] ARE IN MILLIMETERS
TOLERANCES ARE:
INCHES METRIC ANGLES
.XX ± .03 .X ± 0.8 ± 1°
XXX ± .010 .XX ± 0.25

MATERIAL
FINISH
DO NOT SCALE DRAWING

ALL MACHINED SURFACES. TOTAL RUNOUT WITHIN .005. BREAK SHARP EDGES .005 TO .010. MACHINED FILLET RADII .005 TO .015. WELDING SYMBOLS PER AWS A2.4. ABBREVIATIONS PER MIL-STD-12.

