

PROPRIETARY AND CONFIDENTIAL

THE INFORMATION CONTAINED IN THIS DRAWING IS THE SOLE PROPERTY OF DYTRAN INSTRUMENTS INC. ANY REPRODUCTION IN PART OR AS A WHOLE WITHOUT THE WRITTEN PERMISSION OF DYTRAN INSTRUMENTS INC. IS PROHIBITED

REVISIONS

REV.	ECN	DESCRIPTION	BY/DATE	CHK	APPR
A	14508	INITIAL RELEASE. SAME AS REV X1.	NDC 10/09/18	KG	

D

D

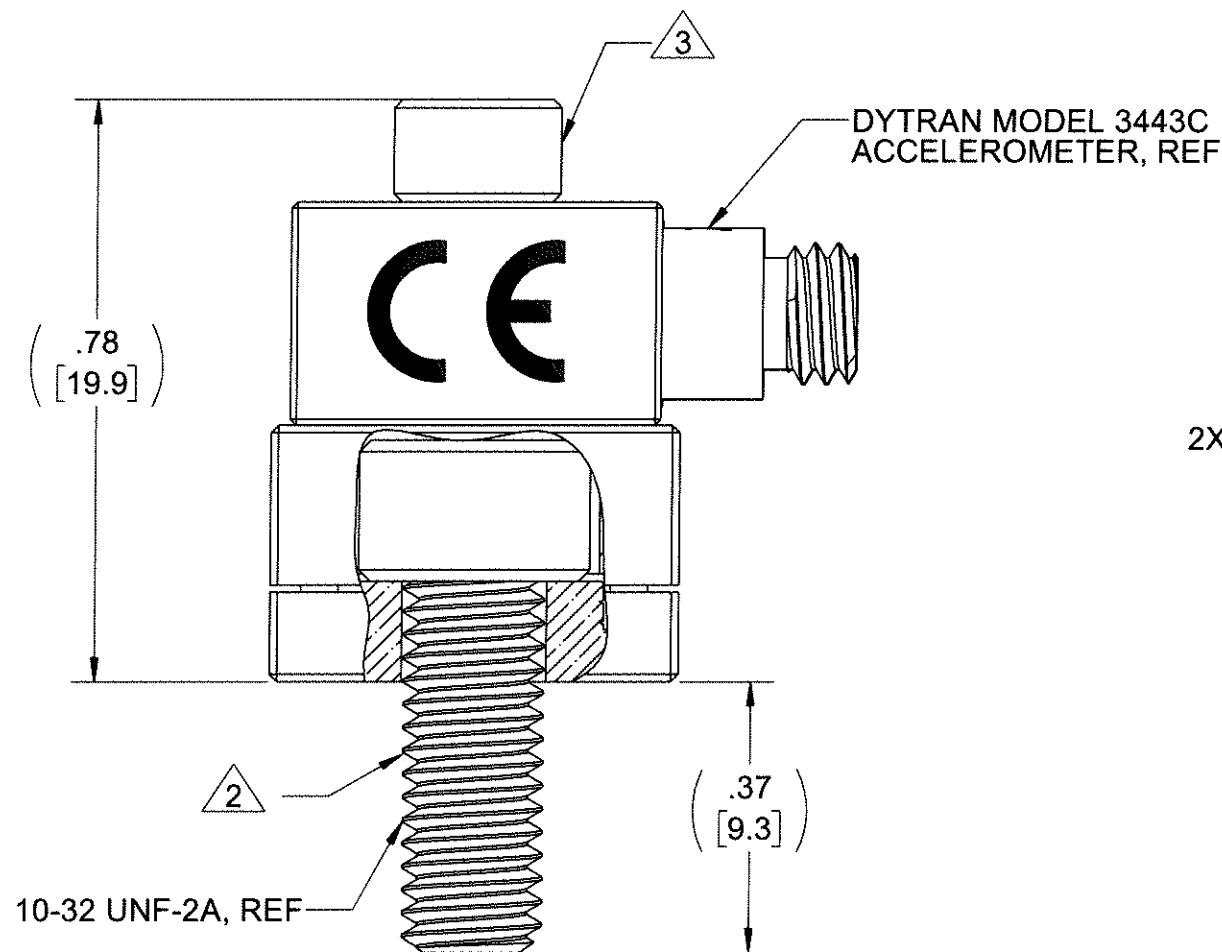

2X 6-32 UNC-2B

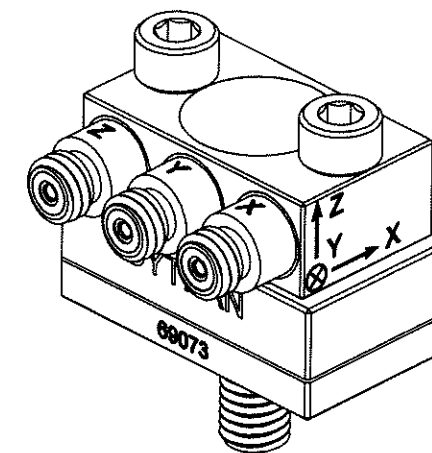
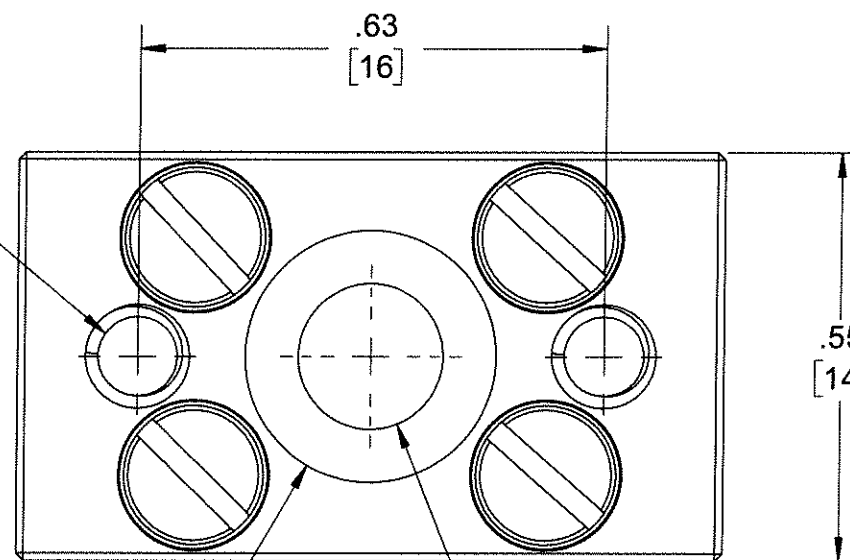

C

C

B

B

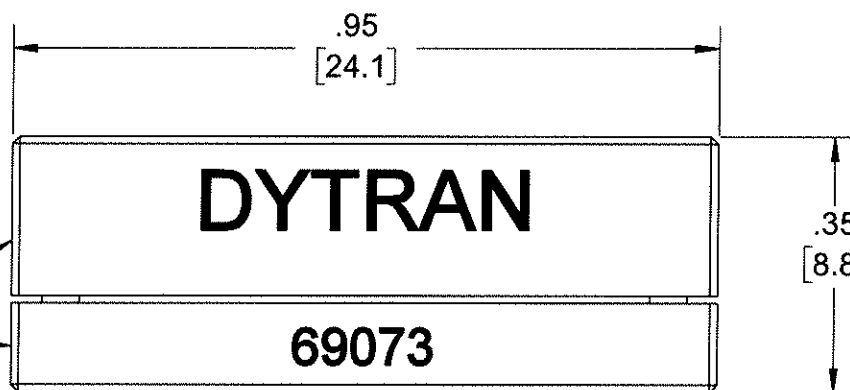
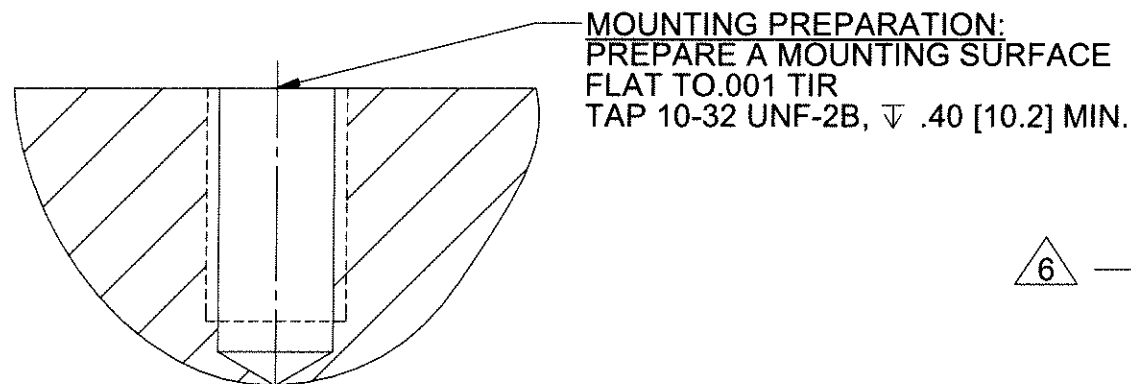

- 6 INSULATION RESISTANCE BETWEEN TOP AND BOTTOM SURFACES: 10 GΩ MIN.
 - 5. MAXIMUM TEMPERATURE RATING: 600°F (316°C.)
 - 4. WEIGHT: 16 GRAMS, MAX.
 - 3 MOUNTING SCREWS, MODEL 6247A2 SUPPLIED WITH ACCELEROMETER.
 - 2 MOUNTING SCREW, MODEL 69055 (10-32 X 1/2") SUPPLIED. MOUNTING TORQUE: 12-14 LB-IN.
 - 1. MATERIAL: TITANIUM ALLOY
- NOTES: UNLESS OTHERWISE SPECIFIED

<small>UNLESS OTHERWISE SPECIFIED: INTERPRET DIM & TOL PER ASME Y14.5M - 1994. REMOVE BURRS. COUNTERSINK INTERNAL THDS 90° TO MAJOR DIA. CHAM EXT THDS 45° TO MINOR DIA. THD LENGTHS AND DEPTHS ARE FOR MIN FULL THDS. DIMENSIONS APPLY AFTER FINISHING.</small>	<small>UNLESS OTHERWISE SPECIFIED: DIMENSIONS ARE IN INCHES DIMENSIONS IN BRACKETS [] ARE IN MILLIMETERS TOLERANCES ARE:</small>				TITLE: OUTLINE/INSTALLATION DRAWING, ISOLATION BASE, THRU HOLE, MODEL 69073	
	<small>DECIMALS .XX ±.03 .XXX ±.010</small>	<small>METRIC .X ±0.8 .XX ±0.25</small>				<small>ANGLES ±1°</small>
	APPROVALS	DATE	SIZE B	CAGE CODE 2W033		DWG NO 127-69073
	<small>ORIG NDC</small> <small>CHK KG</small> <small>APP </small>	<small>09/25/18</small> <small>10/12/18</small> <small>10/16/18</small>	<small>REVISIONS</small>	<small>REV A</small>		
<small>ALL MACHINED SURFACES. TOTAL RUNOUT WITHIN .005. BREAK SHARP EDGES .005 TO .010. MACHINED FILLET RADII .005 TO .015. WELDING SYMBOLS PER AWS A2.4. ABBREVIATIONS PER MIL-STD-12.</small>	<small>DO NOT SCALE DRAWING</small>		SCALE: 2:1	SHEET 1 OF 1		

A

A