

REVISIONS					
REV.	ECN	DESCRIPTION	BY/DATE	CHK	APPR
A	15327	INITIAL RELEASE	KG 02/17/20	AM	[Signature]

**PROPRIETARY AND CONFIDENTIAL**

THE INFORMATION CONTAINED IN THIS DRAWING IS THE SOLE PROPERTY OF DYTRAN INSTRUMENTS INC. ANY REPRODUCTION IN PART OR AS A WHOLE WITHOUT THE WRITTEN PERMISSION OF DYTRAN INSTRUMENTS INC. IS PROHIBITED

MODEL	RANGE
4400B1	±2g
4400B2	±19g
4400B3	±200g

HARDWARE CHECK / READY INDICATOR LED

RECORDING INDICATOR LED

CHARGING INDICATOR LED

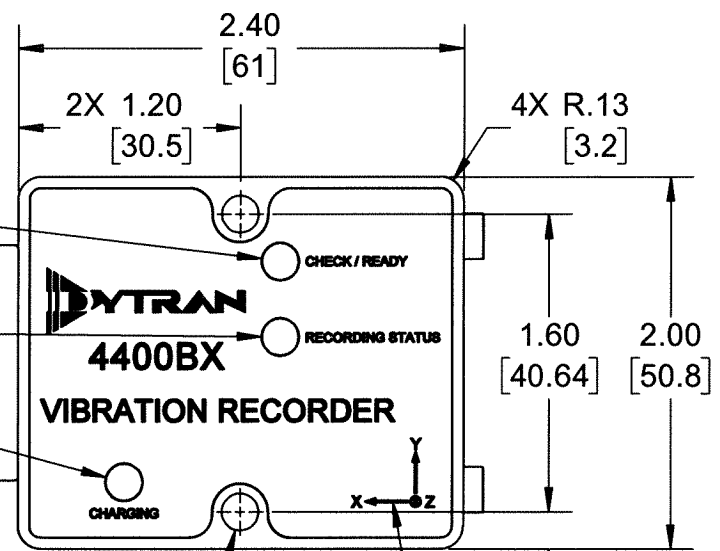

2X Ø.20 THRU [5.1]      .20 [5.1]

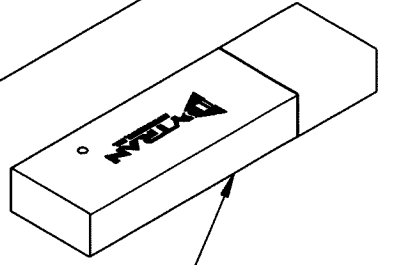
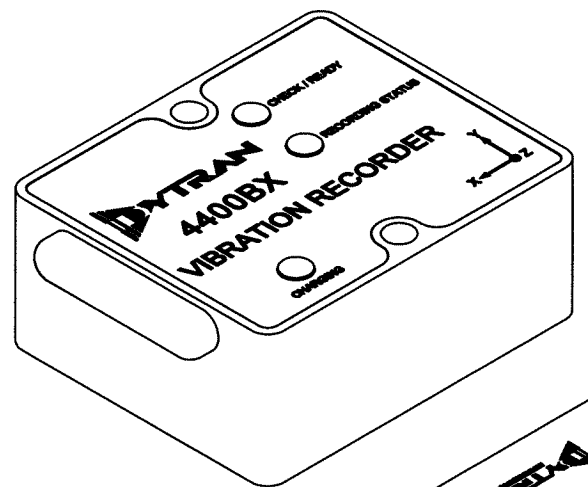
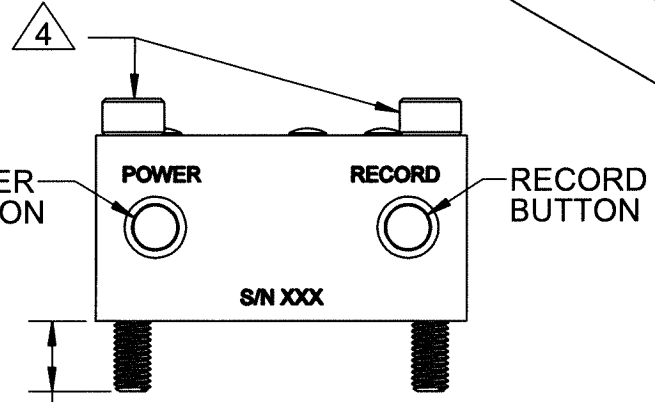

9007 SOFTWARE, SUPPLIED

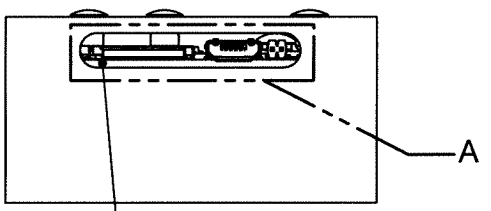

MOLDED COVER NOT SHOWN FOR CLARITY

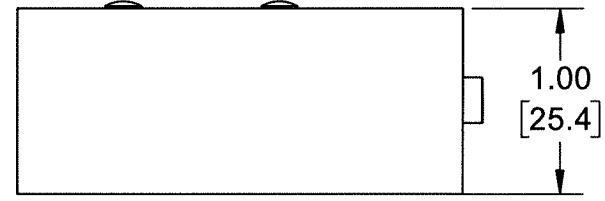

RARE EARTH MAGNETS, PERMANENTLY INSTALLED

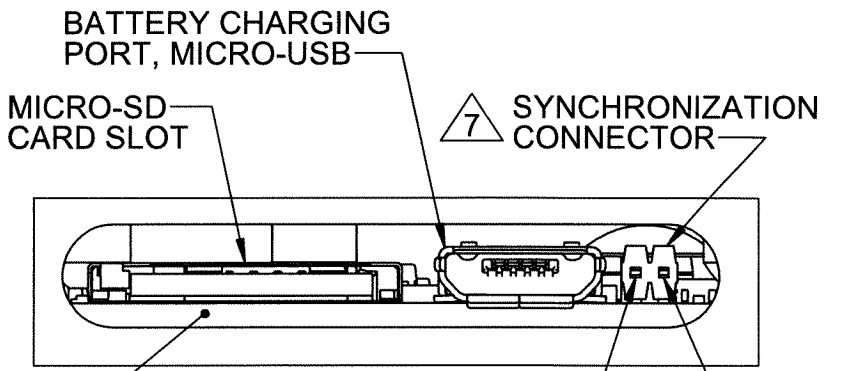

MICRO-SD CARD SLOT

SYNCHRONIZATION CONNECTOR

DETAIL A  
SCALE 3:1

MOLDED COVER

BOTTOM COVER, REMOVABLE

- 8 MOLDED COVER AND BOTTOM COVER MUST BE INSTALLED TO MEET IP RATING.
  - 7 MATING SYNCHRONIZATION CABLE: DYTRAN MODEL 60153AXX.
  - 6 ARROWS INDICATE DIRECTIONS OF ACCELERATION FOR POSITIVE OUTPUT.
  - 5 MAGNETS PULL RATING: UP TO 8.4 lb.  
NOTE: MAXIMUM PULL RATINGS ARE BASED ON DIRECT CONTACT WITH RUST-FREE AND UNPAINTED IRON PLATE. VARIATIONS IN MATERIAL CONDITION WILL SIGNIFICANTLY REDUCE THESE RATINGS.
  - 4 MOUNTING SCREW, MODEL 6246, 10-32 UNF-3A X 1.25, QTY 2, SUPPLIED.  
MOUNTING SCREW, MODEL 6694A1, M5 X 0.8 X 35mm, QTY 2, SUPPLIED.
  - 3. OPERATING TEMPERATURE, DISCHARGING: -4°F TO +140°F (-20°C TO +60°C)  
OPERATING TEMPERATURE, CHARGING: +32°F TO +113°F (0°C TO +45°C)
  - 2. HOUSING MATERIAL: ALUMINUM ALLOY, ANODIZED, COLOR: BLUE.
  - 1. WEIGHT: 150 GRAMS, MAX.
- NOTES: UNLESS OTHERWISE SPECIFIED

UNLESS OTHERWISE SPECIFIED: INTERPRET DIM & TOL PER ASME Y14.5M - 1994. REMOVE BURRS. COUNTERSINK INTERNAL THDS 90° TO MAJOR DIA. CHAM EXT THDS 45° TO MINOR DIA. THD LENGTHS AND DEPTHS ARE FOR MIN FULL THDS. DIMENSIONS APPLY AFTER FINISHING.		UNLESS OTHERWISE SPECIFIED: DIMENSIONS ARE IN INCHES. DIMENSIONS IN BRACKETS [ ] ARE IN MILLIMETERS TOLERANCES ARE:	
DECIMALS .XX ±.03 .XXX ±.010	METRIC X ± 0.8 .XX ± 0.25	ANGLES ±1°	
APPROVALS		DATE	
ORIG	KG	10/18/19	
CHK	AM	03/12/20	
APP	[Signature]	5/12/20	
DO NOT SCALE DRAWING		THIRD ANGLE PROJECTION USA	

**DYTRAN INSTRUMENTS, INC.** Chatsworth, CA

**MASTER ONLY IF IN RED**

TITLE: **OUTLINE/INSTALLATION DWG, VIBRATION RECORDER, MODEL 4400B**

SIZE <b>B</b>	CAGE CODE <b>2W033</b>	DWG NO <b>127-4400B</b>	REV <b>A</b>
------------------	---------------------------	----------------------------	-----------------

SCALE: 1:1      SHEET 1 OF 1

<b>MODEL NUMBER</b> <b>4400B3</b>	<b>PERFORMANCE SPECIFICATIONS</b>	<b>DOC NO.</b> <b>PS4400B3</b>
	<b>ACCELERATION RECORDER, TRIAXIAL</b>	REV A, ECN 15327, 02/24/20



- RECORDS THREE-AXIS VIBRATION UP TO 15 HOURS
- IP64 RATED
- MICRO-SDHC CARD COMPATIBLE
- DUAL MOUNTING CONFIGURATIONS
- INTEGRATED ANTI-ALIASING FILTERS

**PHYSICAL**

Weight, Max.  
Mounting  
Housing Material

ENGLISH		SI	
Weight, Max.	5.3 oz	Weight, Max.	150 grams
Mounting	Screws / Magnets	Mounting	Screws / Magnets
Housing Material	Aluminum, Anodized	Housing Material	Aluminum, Anodized

**PERFORMANCE**

Acceleration Range  
Maximum Frequency Range, -3dB  
Resonance Frequency  
Linearity [1]  
Transverse Sensitivity, Max  
Noise, Max.  
Recording Time, Max.  
Sampling rate  
Memory Card Type  
Acquisition Type

ENGLISH		SI	
Acceleration Range	±200 Gpeak	Acceleration Range	±1962 m/s <sup>2</sup> peak
Maximum Frequency Range, -3dB	0 to 1000 Hz	Maximum Frequency Range, -3dB	0 to 1000 Hz
Resonance Frequency	>5.5 kHz	Resonance Frequency	>5.5 kHz
Linearity [1]	< ±2.0 %F.S.	Linearity [1]	< ±2.0 %F.S.
Transverse Sensitivity, Max	5 %	Transverse Sensitivity, Max	5 %
Noise, Max.	0.2 G rms	Noise, Max.	1962 mm/s <sup>2</sup> rms
Recording Time, Max.	15 hours	Recording Time, Max.	15 hours
Sampling rate	100 - 10,000 samples/s	Sampling rate	100 - 10,000 samples/s
Memory Card Type	Micro-SDHC	Memory Card Type	Micro-SDHC
Acquisition Type	Free Run / Triggered / Time	Acquisition Type	Free Run / Triggered / Time

**ELECTRICAL**

Battery

Battery	1300mAh (Rechargeable)	Battery	1300mAh (Rechargeable)
---------	------------------------	---------	------------------------

**ENVIRONMENTAL**

Shock Max  
Vibration Max  
Operating Temperature, Discharging  
Operating Temperature, Charging  
Seal [3]

ENGLISH		SI	
Shock Max	1,000 g pk	Shock Max	9810 m/s <sup>2</sup>
Vibration Max	250 g pk	Vibration Max	2453 m/s <sup>2</sup>
Operating Temperature, Discharging	-4 to +140 °F	Operating Temperature, Discharging	-20 to +60 °C
Operating Temperature, Charging	+32 to +113 °F	Operating Temperature, Charging	0 to +45 °C
Seal [3]	Environmental / IP64	Seal [3]	Environmental / IP64

Model	Range (Gpeak)	Noise (G rms)	Oper. Temp (°F)	BandWidth (Hz)
4400B1	±2	0.01	-4 to +140	0 to 1000
4400B2	±19	0.02	-4 to +140	0 to 1000

Refer to the performance specifications of the products in this family for detailed description

**Supplied Accessories:**

- 1) Accredited calibration certificate (ISO 17025)
- 2) Mounting Screw, Model 6246, 10-32 X 1.25, Qty. 2
- 3) Mounting Screw, Model 6694A1, M5x0.8 X 35mm, Qty. 2
- 4) 9007 Software

**Notes:**

- [1] Linearity is % of specified full scale (or any less full-scale range), zero-based best fit straight line method.
- [2] In the interest of constant product improvement, we reserve the rights to change the specifications without notice. It is the customer's responsibility to validate that a particular product with the properties described in the product specification is suitable for use in a particular application. Parameters provided in datasheets and / or specifications may vary in different applications and performance may vary overtime. All operating parameters, including typical parameters, must be validated for each customer application by the customer's technical experts.
- [3] Molded cover and bottom cover with integral sealing gasket must both be installed to meet IP64 rating.

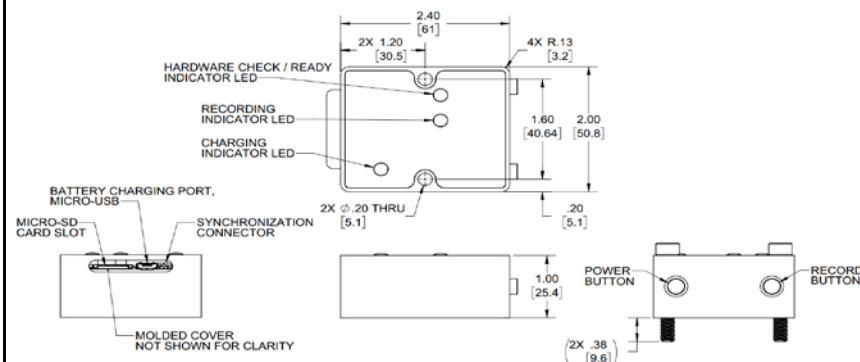

Units on the line drawing are in inches, units in brackets are in millimeters. Refer to 127-4400B for more information.



21592 Marilla Street, Chatsworth, California 91311 Phone: 818.700.7818 Fax: 818.700.7880 www.dytran.com For permission to reprint this content, please contact info@dytran.com